

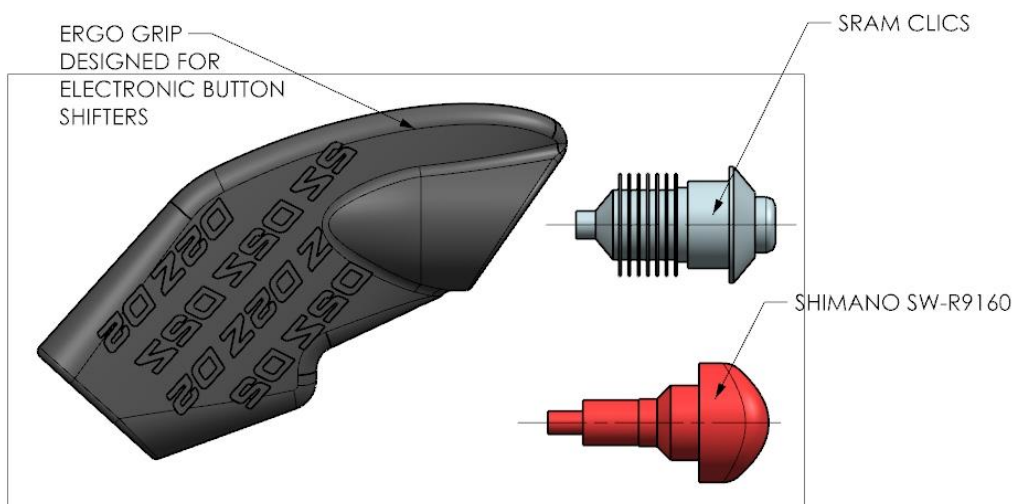

## Ski Pole end grips

For improved ergonomics and aero dynamics, our ski poles have an elliptical end section. So that you can insert your gear shifters into the pole we supply a range of end grips which turn that elliptical shape into a circular shape.

### USP Ergo Grip



For the ultimate comfort, ergonomics and aerodynamics, we recommend the ergo grip. This provides a very neutral hand grip which encourages the rider to relax their wrist and hand and this promotes a slightly curved shape to the top of the hand (similar to the S-bend adapter offered on our standard ski pole).

The grip is manufactured from a semi soft plastic material, and only works with the small electronic shift buttons from SRAM and Shimano.

Due to the height and size of the Ergo grip, the majority of athletes find that it is not possible to position the USP pole and ergo grip within the UCI regs given that the wrist inflexion point on the bar needs to be as close as possible to the 80cm or 85cm reach regulation.

The position of the ski pole on the USP pole tends to be similar for most people. The max recommended trim line is 55mm, usually the grip will be optimal at 45 to 50 mm.

**Dimensions of Ergo grip giving additional length and height with the use of High rise pole and angled shims at 10,15 and 20 degrees**

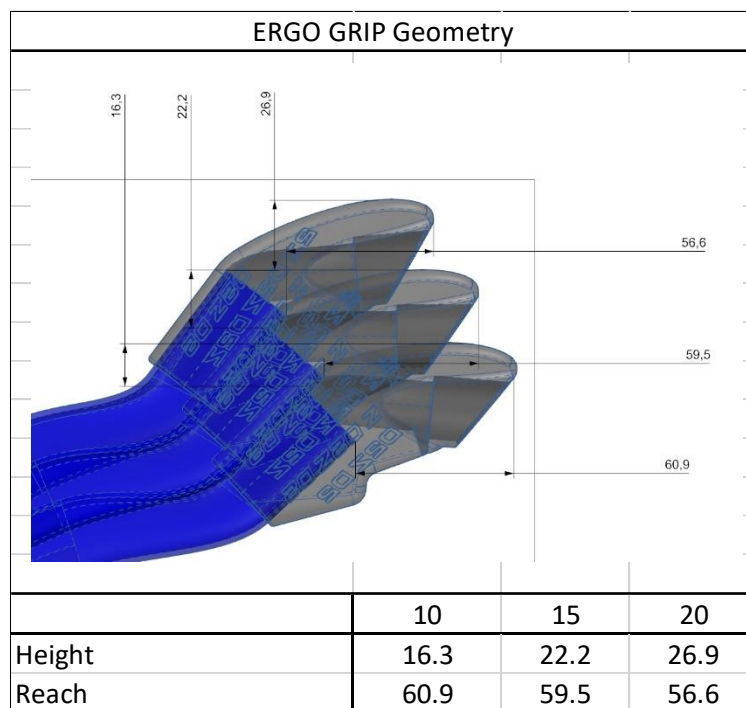

## Straight end grips

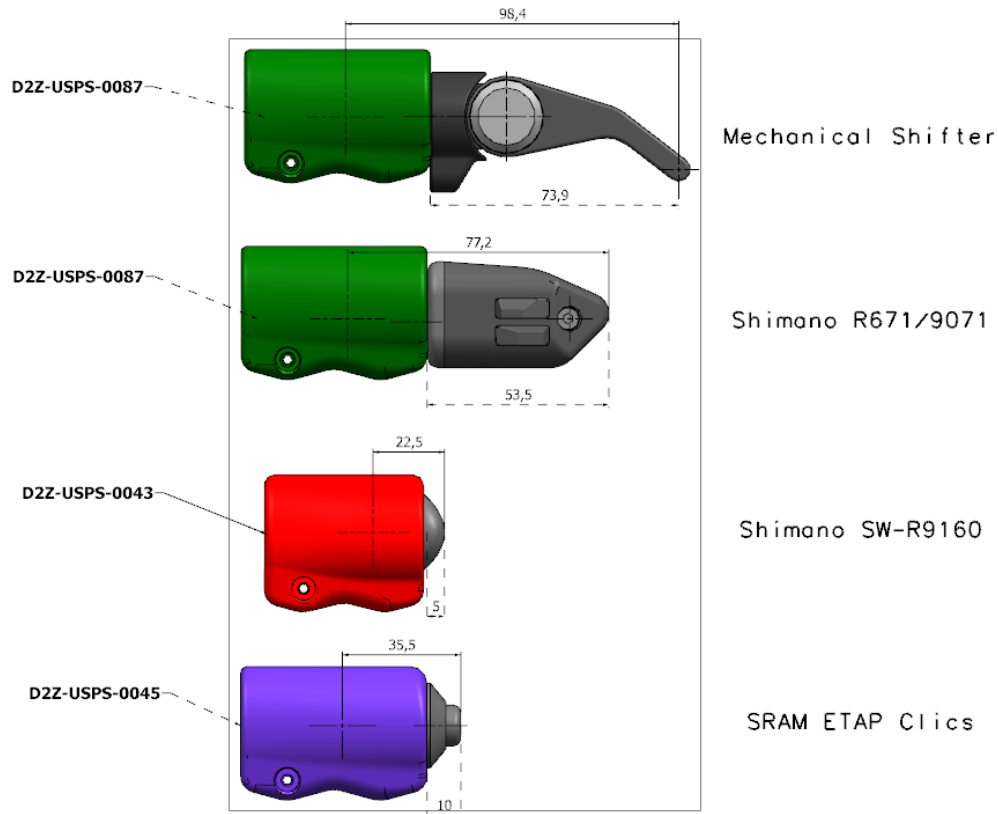

These simple end grips offer the most cost effective solution and means to attach any shifter to the elliptical ski pole. For UCI applications where reach restrictions make it difficult for the rider to stretch out, the short SRAM and Shimano button shifters give the most scope for maximising the space for the rider.

Solutions are offered for mechanical shifting, as well as the earlier Shimano style Di2 R671 and Dura Ace Di2 9071 series of single and double button shifters. These shifters have a short grip (D2Z-USPS-0087) so that you do not require the expander bolt.

The **Shimano R9160** can be pressed into the short grip (D2Z-USPS-0043) with the expander bolt removed.

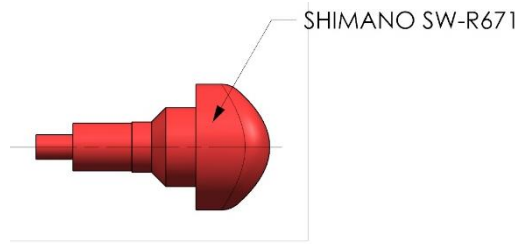

The **SRAM etap clic** uses a slightly longer grip (D2Z-USPS-0045).

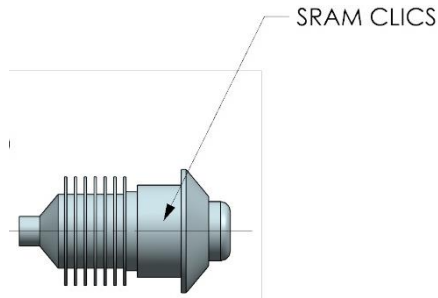

Athletes that use the **SRAM blips** have been able to tape the shifters to the side or end of the carbon ski pole.

Dimensions given in the diagram indicate the additional grip length that is added to the assembly. Each straight grip has an overlap/engagement length of 30 mm onto the carbon pole.